

dexcomG6

START HERE

Set up

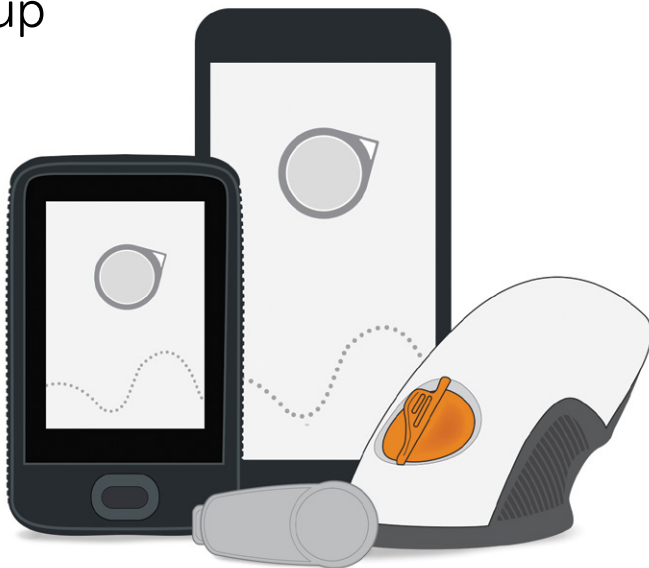

Instructions For Use

Dexcom G6 CGM (G6) Overview

Display Device

- Shows glucose information
- Set up your smart device, Dexcom receiver, or both
- For a list of current compatible smart devices and operating systems go to: dexcom.com/compatibility
- The G6 app and receiver are compatible with all G6 systems

Your smart device

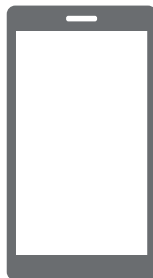

Dexcom receiver



Applicator With Built-in Sensor

- Sensor applicator inserts sensor under your skin
- Sensor gets glucose information

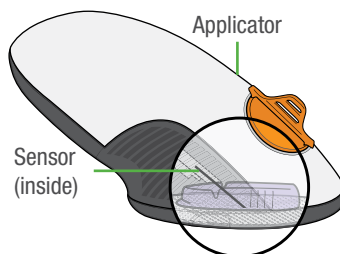

Transmitter

- Sends glucose information from sensor to display device

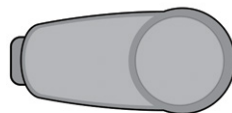

All graphics are representational. Your product may look different.

Review the Safety Statement in *Using Your G6, Chapter 2* before using your G6.

What It Does

The G6 sends G6 sensor glucose readings (G6 readings) to your display device.



Choose App, Receiver, or Both

The receiver is a dedicated medical device. Your smart device is not, even though you can run the G6 app on it. Your smart device is not a dedicated medical device because the app could miss an alarm/alert just because it is on a smart device—for example, due to smart device settings, smart device or app shutting off, low battery, etc.

Use tabs below to set up the app, receiver, or both

Want to set up both? Pick one to set up first and turn to that tab. The last step shows you how to set up the second display device. Do not use both tabs.

For other ways to learn how to set up your G6:

- Watch the tutorial at: dexcom.com/downloadsandguides
- Contact your local Dexcom representative for support

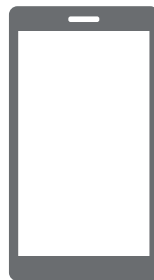

Your smart device



Dexcom
receiver



Your smart device

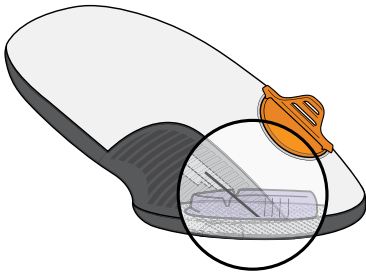

Applicator with
Built-in Sensor

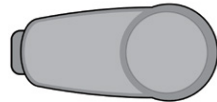

Transmitter

Set Up App

Step 1: Set Up App

A Download and open the Dexcom G6 app



B Follow onscreen setup instructions

1 When prompted:

- Send your data to the cloud.
This lets you use:
 - Share: Send your G6 data to followers.
 - CLARITY: Reflect on data with doctors; see patterns (may not be available in all regions).
- Enter your Sensor code
(from the sensor applicator you will insert).
- No sensor code?
See Using Your G6, Appendix A Troubleshooting.

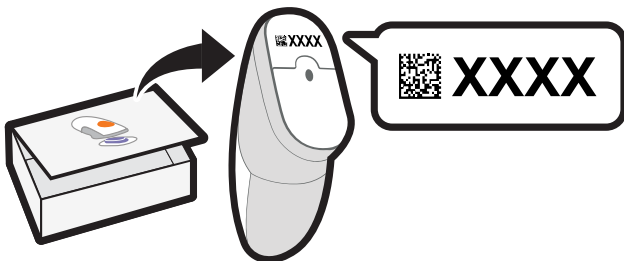

- Enter your Serial Number (SN) from:

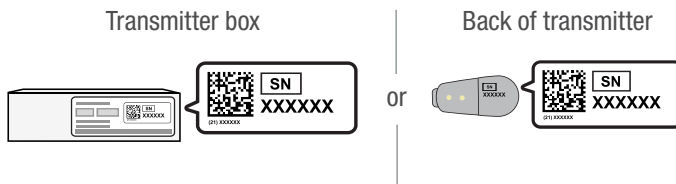

After you enter your SN, your G6 searches for the transmitter. While it is searching, you will not get G6 readings or alarm/alerts.

- 2 See the blue sensor warmup timer?
That means your sensor is getting used to your body.

During warmup:

- No G6 readings or alarm/alerts
- Always keep smart device within 6 meters of transmitter

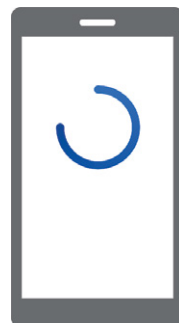

C Wait 2 hours

- When sensor warm-up is complete, tap **OK** to see the home screen
- Now you get G6 readings and alarm/alerts

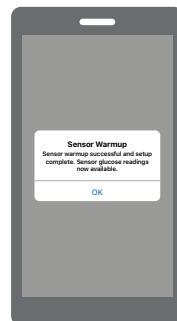

Step 2: See *Using Your G6*

Learn how to:

- Read your home screen
- Use alarm and alerts
- Make treatment decisions
- Troubleshoot issues



Step 3: Optional – Set up Receiver

Turn on the receiver by pressing the power button down for 2-3 seconds. Then follow onscreen instructions.

Do not use the Set Up Receiver tab. Those steps are for setting up the receiver before setting up the app.

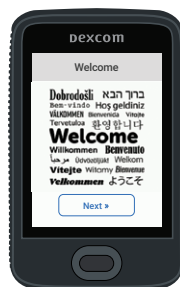

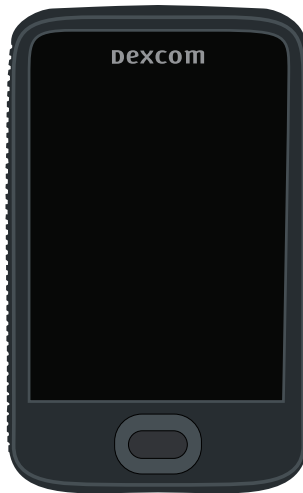

Receiver

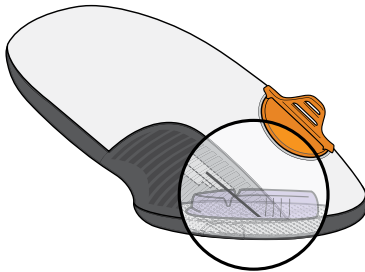

Applicator with
Built-in Sensor

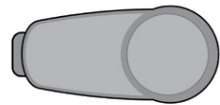

Transmitter

Set Up Receiver

Step 1: Set Up Receiver

A Take receiver out of box



B Turn on receiver

Press power button for 2-3 seconds.



C Follow onscreen instructions

- 1 When prompted, enter your:
 - Sensor code from the sensor applicator you will insert
 - No sensor code?
See Using Your G6, Appendix A Troubleshooting

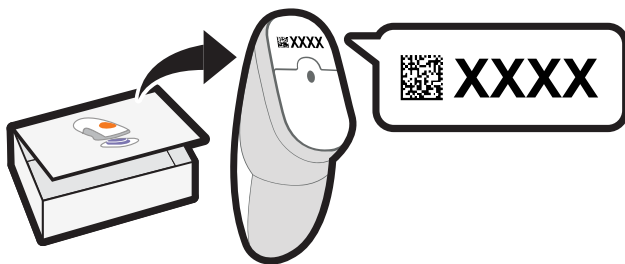

- Serial Number (SN) from:

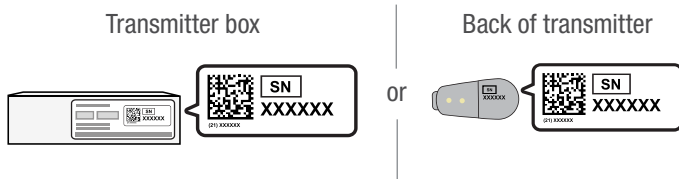

After you enter your SN, your G6 searches for the transmitter. While it is searching, you will not get G6 readings or alarm/alerts.

- 2** You are done with this step when you see this screen:

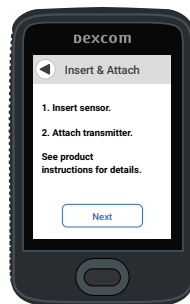

Step 2: Use Applicator to Insert Built-in Sensor

A Take applicator with built-in sensor out of sensor box

Gather materials: applicator (with code you just entered), transmitter, and wipes.

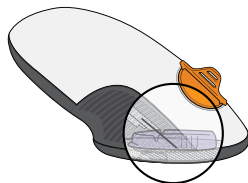

B Pick sensor site

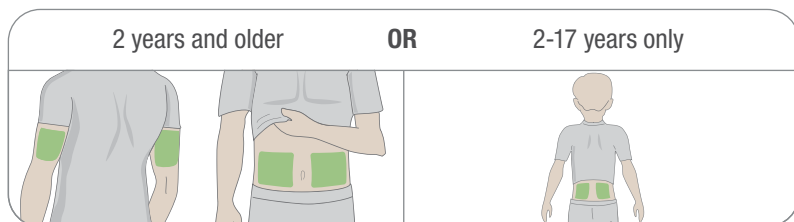

Avoid bones, irritated skin, tattoos, and areas that get bumped.

C Use applicator to insert built-in sensor

- 1 Get sensor applicator and an alcohol wipe.

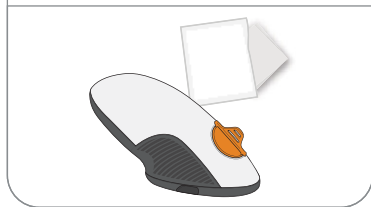

- 2 Wash and dry hands.

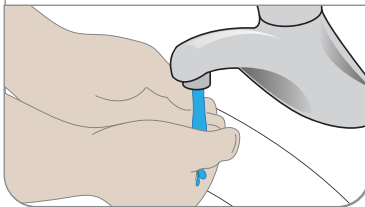

- 3** Clean sensor site with alcohol wipe.

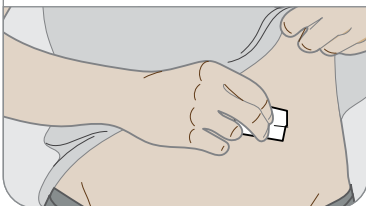

- 4** Peel off adhesive backings. Do not touch adhesive.

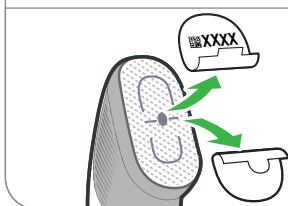

- 5** Place applicator on skin.

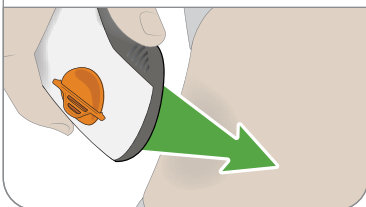

- 6** Fold and break off safety guard.

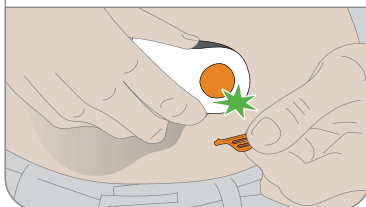

- 7** Press button to insert sensor.

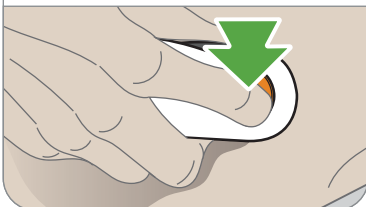

- 8** Remove applicator from skin leaving patch and holder on.

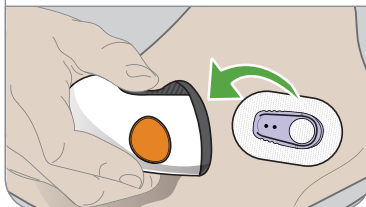

- 9** Discard applicator. Follow local guidelines for blood-contacting components.

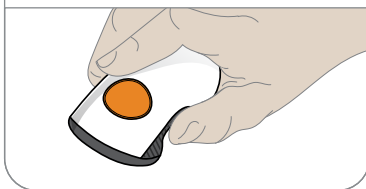

Step 3: Attach Transmitter

A Take transmitter out of box

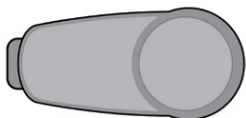

B Snap in transmitter

- 1** Clean transmitter with alcohol wipe.

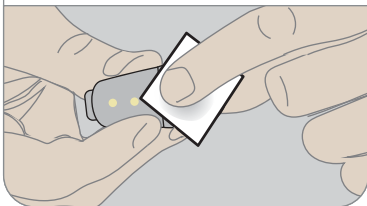

- 2** Insert transmitter, tab first, into holder.

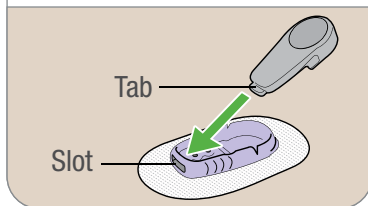

- 3** Snap in transmitter. It clicks into place. Make sure it is flat and snug in holder.

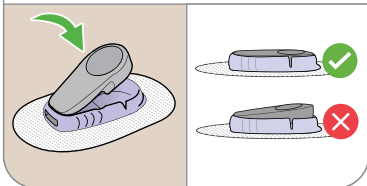

- 4** Rub around patch 3 times.

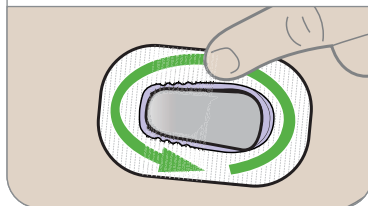

Step 4: Start Sensor on Receiver

A Wait up to 30 minutes for pairing

During pairing:

- No G6 readings or alarm/alerts
- Always keep receiver within 6 meters of transmitter



B Tap Start Sensor to begin 2-hour warmup

During warmup you will not get G6 readings or alarm/alerts

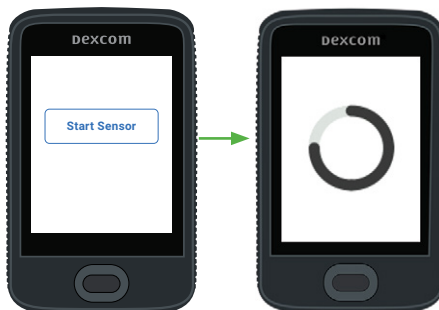

C Wait

- When complete, tap **Next** to go to home screen
- Now you get G6 readings and alarm/alerts



Step 5: See *Using Your G6*

Learn how to:

- Read your home screen
- Use alarm and alerts
- Make treatment decisions
- Troubleshoot issues



Step 6: Optional - Set up App

Download the app onto your smart device and open it. Then follow onscreen instructions.

Do not use the Set Up App tab. Those steps are for setting up the app before setting up the receiver.





© 2019 Dexcom, Inc. All rights reserved.

Covered by patents dexcom.com/patents.

Dexcom, Dexcom Share, Dexcom Care, Dexcom Clarity, and Share are registered trademarks of Dexcom, Inc. in the United States and may be in other countries.

Dexcom



Dexcom, Inc.
6340 Sequence Drive
San Diego, CA 92121 USA

+1.858.200.0200
dexcom.com

Outside US: Contact your local
Dexcom representative



MDSS GmbH
Schiffgraben 41
30175 Hannover, Germany

